

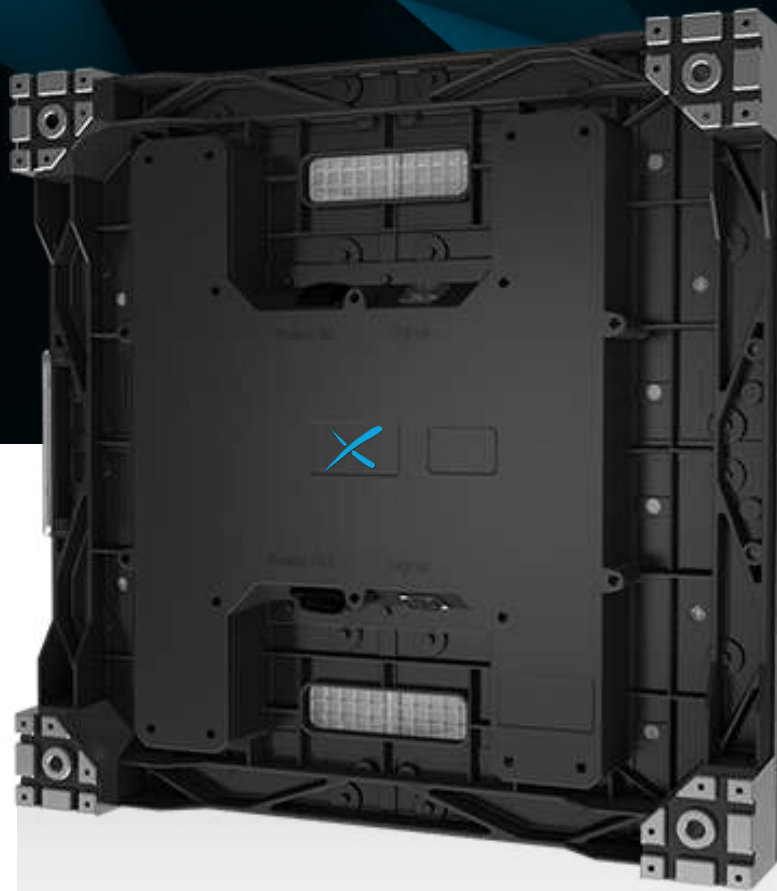

OPAL

HIGH RESISTANCE LED FLOOR













OVERVIEW

The OPAL is an excellent LED interactive floor display, with an extremely short response time, high stability, and a load capacity of over 2000kg/sqm. Its adjustable feet and easy front access maintenance make for quick and flawless integration. The OPAL can have up to 16 quick response touch points per module (option), allowing for a unique interactive experience without any delay.



-  **APPLICATION**
Indoor
-  **BRIGHTNESS**
≤ 3000 NITS @ 5 volts
-  **INGRESS PROTECTION**
IP65
-  **WEIGHT**
15 - 13 kg/cabinet
-  **PIXEL PITCH**
P2.6 P2.9 P3.9 P5.2 P6.2
-  **MATERIAL**
Aluminum
-  **DISPLAY AREA (W x H)**
500 x 500 mm
-  **MAINTENANCE**
Front maintenance



FEATURES

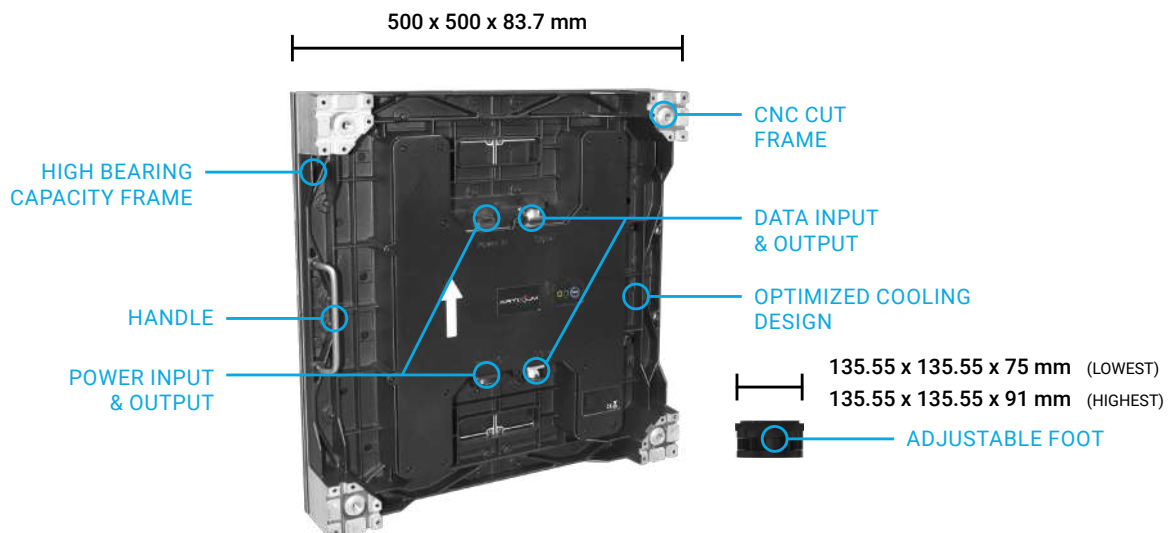



QUICK RESPONSE TIME

Depending on the pixel pitch, the modules can each contain from 4 to 16 touchpoints with a 33ms response time (less than 0.033s). This option gives you the ability to create unique interactions between your audience and your LED

installation concept. You can also enhance your dynamic and interactive installation by triggering both visuals and sound effects. The OPAL offers endless possibilities for showrooms, museums, shows, and so on.



ADJUSTABLE FEET



QUICK AND EASY INTEGRATION



HIGH BEARING CAPACITY

FRONT MAINTENANCE

Each module of the OPAL can be removed and replaced from the front thanks to a vacuum tool that allows for a quick intervention, if needed.

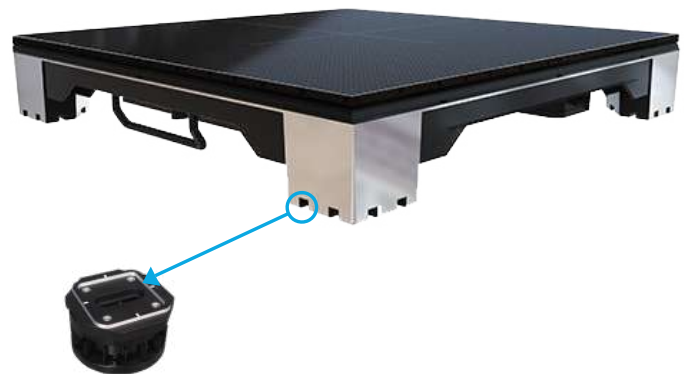

ULTRA RESISTANT

The OPAL LED floor application is waterproof and highly resistant to shocks and heavyweight, bearing up to 2t/sqm. It is designed to withstand a tremendous amount of use without taking any damage.

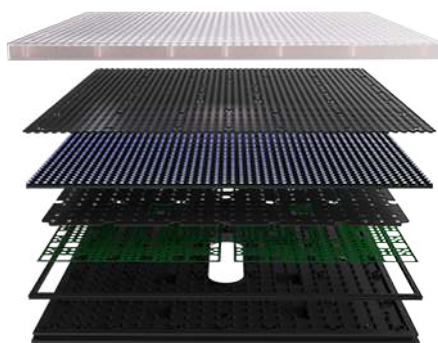

EASY INTEGRATION

The OPAL adjustable feet are designed to allow a quick assembly of the different cabinets. Once one of them is placed on the floor, the feet will serve as guides for the other cabinets to fit perfectly. Combined with the ability to adjust the height, allows for flawless and quick integration.



TECHNICAL SPECIFICATIONS

		INDOOR				
Product Parameters	Unit	2.6	2.9	3.9	5.2	6.2
Pixel Pitch	mm	2,60	2,98	3,91	5,21	6,25
LED		SMD1010	SMD1516		SMD1921	
Application		LED floor				
Ingress Protection	IP	IP65				
Brightness	cd/sqm	≤ 600Nits @5volts		≤ 2600Nits @5volts		≤ 3000Nits @5volts
Color Temperature after calib (adjustable)	deg. K	5500 - 9500 Adjustable				
Viewing Angle (50% brightness)	deg.	120 L / 120 H				
Cabinet Size (WxHxD)	mm	500 x 500 x 85				
Display area (WxH)	mm	500 x 500				
Module Size (WxHxD)	mm	250 x 250 x 14.5				
Pixel Matrix Per Cabinet (WxH)	px	192 x 192	168 x 168	128 x 128	96 x 96	80 x 80
Pixel Matrix Per Module (WxH)	px	96 x 96	84 x 84	64 x 64	48 x 48	40 x 40
Pixel Density	px/sqm	147456	112896	65536	36864	25600
Weight of cabinet	kg	15				
Cabinet Material		Aluminum				
Maintenance Mode		Front				
Mask specification		Transparent high resistance mask with integrated black film (hot molded)				
Contrast Ratio		Élevé				
Grey scale (linear)	bit	14				
Brightness control	bit	16				
Processing depth	bit	16				
Color		281 Trillions				
Display Refresh Rate	Hz	1920				
Operation Power	V	100V-240V AC				
Max. Power Consumption	W/sqm	600		800		
Average Power Consumption	W/sqm	200		240		
Control Mode		Synchronization				
Video Frame Rate	Hz	50/60Hz				
Input Types Supported		DVI/SDI/HDMI				
3D ready (optional)		Non				
Calibration		Yes				
Lifetime (50% brightness)	h	100000				
Operating Humidity Range		10% - 90%				
Operating Temperature Range		-30°C / +40°C				
Screen Uniformity Correction		-				
Certification		FCC / CE / ETL / CCC / CB				
Available options		Interactivity				
Compatibility		No				



Information and design in this leaflet are subject to Artixium France SAS copyright. No material from this leaflet can be used in any context without ARTIXIUM approval. Designs and specifications are subject to change without notice. All images of ARTIXIUM products components and accessories used here are also subject to change without notice. All information presented herein is based on the latest information at the time of publishing. Actual results of performance and other specifications may differ or vary with production models and may depend on selected options and model ranks.



TECHNICAL DRAWINGS

500 x 500 mm CABINET

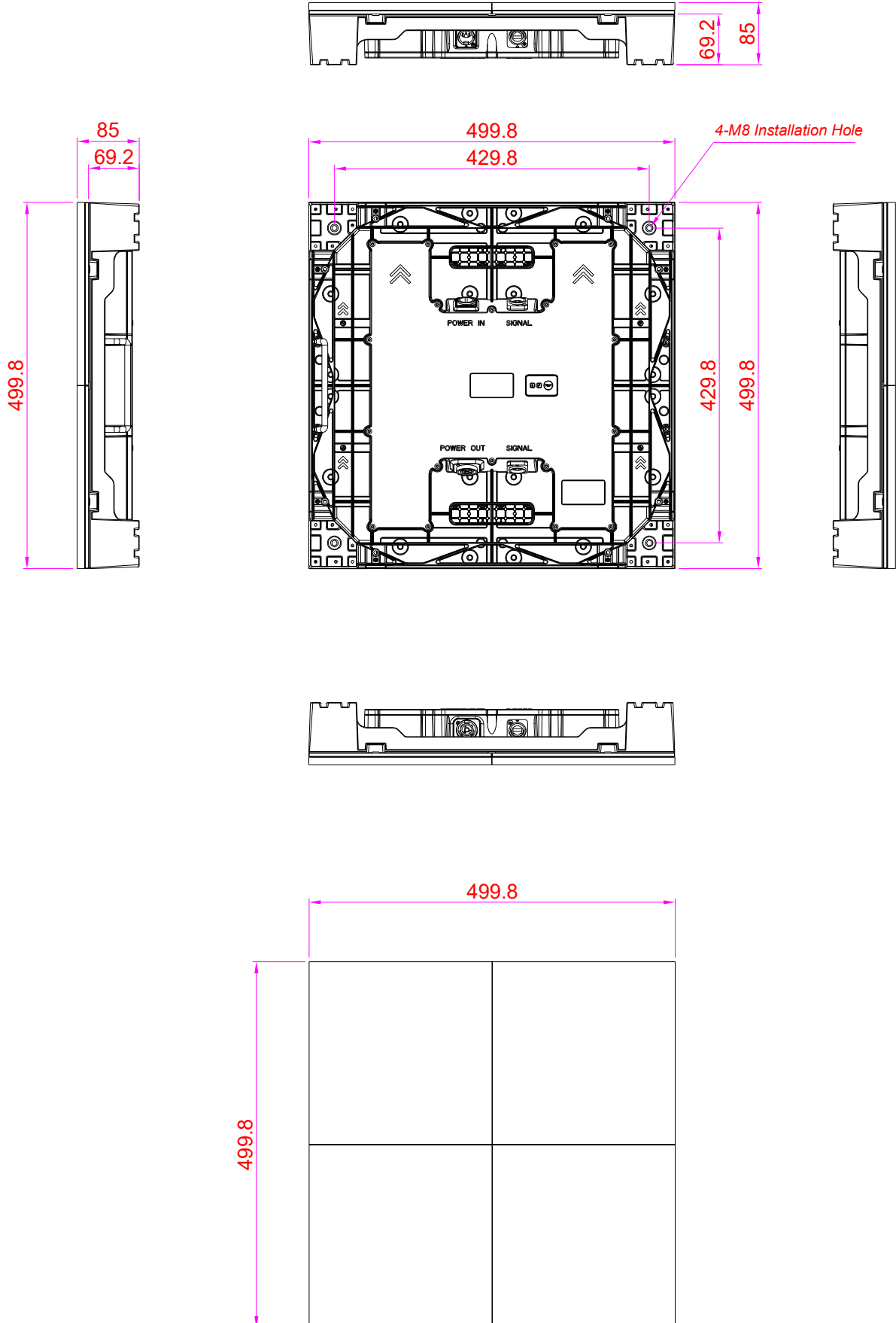



TECHNICAL DRAWINGS

CONNEXION PLATES & ASSEMBLY

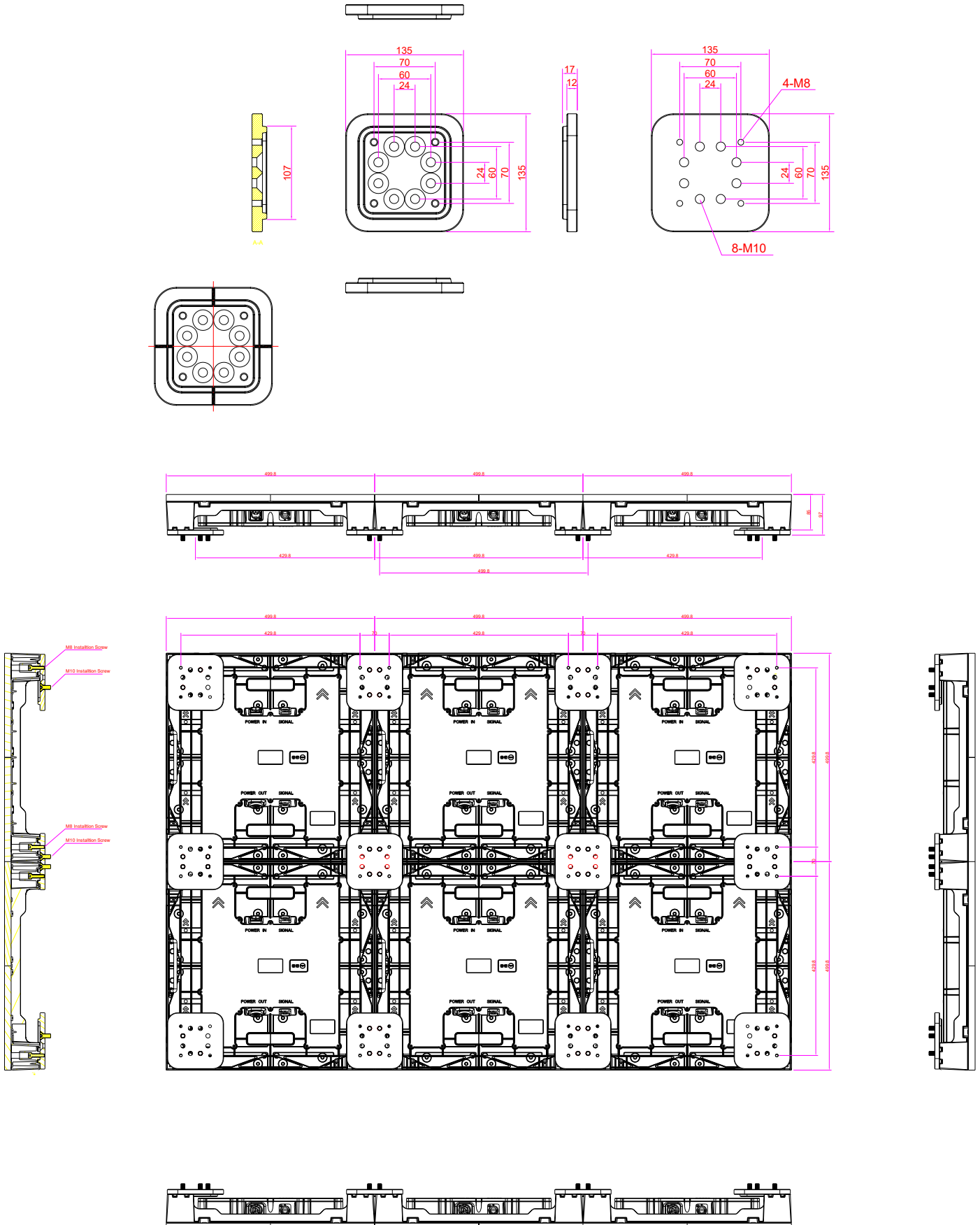



TECHNICAL DRAWINGS

ADJUSTABLE FEET

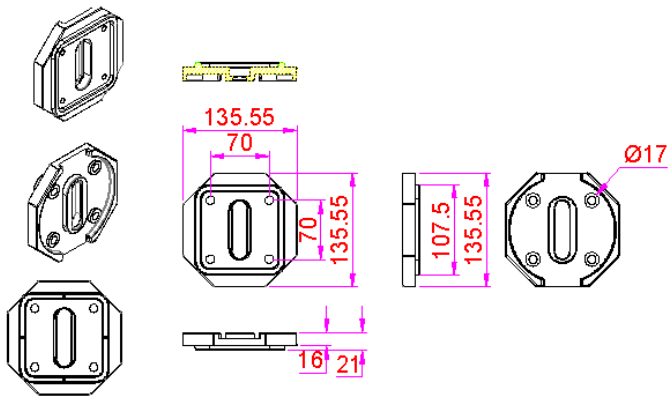
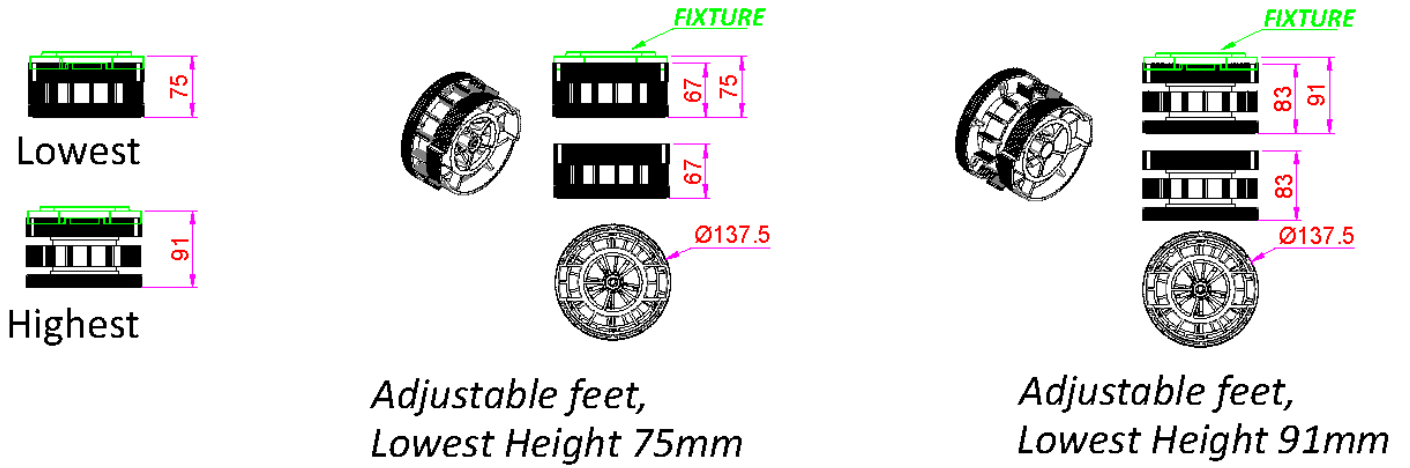



CONTACT

The Artixium regional branches are the key for the growth and development of our global network all over the world. Artixium's team is a spectrum of different nationalities and cultures, reflecting their global presence and mindset, mak-

ing their communication smooth and hassle-free with clients from all around the world. Customer care, Innovation and flexibility has always been our values and we intend to keep this reputation for many years to come.

ARTIXIUM FRANCHISES

"From your project's conception to its completion."



112 Avenue Franklin Roosevelt
69120 Vaulx-en-Velin
France



Artixium Operational Center
518000 Shenzhen
China



Weissensteinstrasse 90b,
46149 Oberhausen
Germany



Merkez Mah. Baglar Cad. A
Blok Apt. No: 14D/13 Kagithane, Istanbul
Turkey



 www.artixium.com

 0 428 001 801

 [linkedin.com/company/artixium](https://www.linkedin.com/company/artixium)

 twitter.com/artixium

 contact@artixium.com

 [youtube.com/@artixium](https://www.youtube.com/@artixium)

 [facebook.com/artixium](https://www.facebook.com/artixium)

 [instagram.com/artixium](https://www.instagram.com/artixium)



Since its creation in 2012 by two european entrepreneurs, Artixium has been evolving and always looking for innovative ways to contribute to the digital transition of our world. It only took a few years for Artixium to become a key player in the LED display industry.

www.artixium.com